

CENTRAL BAPTIST CHURCH

179 Years



"Making Disciples...Transforming Lives!"

April 20, 2025 | Vol.10/Issue 8

WORSHIP | SUNDAYS | 10 AM



@CBCSTL | CBCSTL.ORG/LIVE



MATTHEW 28:6
HE IS NOT HERE, FOR HE HAS
RISEN, AS HE SAID. COME, SEE
THE PLACE WHERE HE LAY.

**Resurrection
Sunday
Worship!**

FEATURING THE CHILDREN'S MINISTRY

Sun 4/20 | 10 AM



@CBCSTL | cbcstl.org/live



DEATH HAS BEEN CONQUERED

CENTRAL SPRING REVIVAL



MAY 6TH

Reverend R. Janae Pitts-Murdock
Light of the World Christian Church
Indianapolis, IN



MAY 13TH

Reverend Dr. John R. Faison, Sr.
Watson Grove Baptist Church (The Grove)
Nashville, TN & Franklin, TN



MAY 20TH



Reverend Dr. Charles E. Goodman, Jr.
Tabernacle Baptist Church
Augusta, GA & Evans, GA



Reverend Anthony L. Riley
Pastor

**OPEN PRAYER
6 PM**

3 Tuesdays | 7 PM

  @CBCSTL | cbcstl.org/live

babydedication

committing our children to the Lord

MOTHER'S DAY
SUNDAY, MAY 11TH
10 AM WORSHIP



REGISTER YOUR CHILD UNDER AGE 2
BY SUNDAY, MAY 4TH

  @CBCSTL | cbcstl.org/live

FORM.JOTFORM.COM/ASKCENTRAL/BABY-DEDICATION

Trust National Leaders With Your Breast Health

BECAUSE WHERE YOU GET YOUR MAMMOGRAM MAKES A DIFFERENCE



Saturday
May 17th, 2025

Appointments from 8:30 am - 12:00 pm

Central Baptist Church
2842 Washington Ave.
St. Louis, MO 63103

Schedule your appointment by calling:
314-747-7222 or 800-600-3606
(press option #2)

The Siteman Cancer Center Barnes-Jewish Hospital
and Washington University is offering
mammograms to women age 40 and over.

Mammograms are available at no cost to patients who qualify.

Patients under the age of 40 must have a provider's order.

Siteman Cancer Center is here regardless of your location.

Trust your breast health to national leaders in cancer screening, treatment and support.

For more information on Siteman Mammogram locations, please visit SitemanMammogram.wustl.edu



Siteman Cancer Center complies with applicable federal civil rights laws and does not discriminate on the basis of race, color, national origin, age, disability or sex. Information may be available in Spanish or Chinese. For more information, please call 314-747-7222 or 800-600-3606. 中文: 免費諮詢及預約服務, 請致電 314-747-7222 或 1-800-600-3606

SitemanMammogram.wustl.edu | 800-600-3606

New Members Class

Saturdays, May 17 & 24th
10 AM-12 PM In-Person & Virtual



Register now!

Includes a Central Campus tour
BOTH SESSIONS REQUIRED



UNDERGRADUATE COLLEGE SCHOLARSHIPS FOR CENTRAL DISCIPLES

ONE SCHOLARSHIP TO BE AWARDED TO A ST. LOUIS AREA,
NON-CENTRAL MEMBER ACTIVE IN ANOTHER CHURCH



Application Deadline:
Sunday, May 18th

cbcstl.org/scholarships

December 2024/School Year 2025
High School Graduates



HS Scholarship



Book Stipend

FINANCIAL AID & CONTINUING EDUCATION (FACE)
CENTRAL BAPTIST SCHOLARSHIP*

MEN OF CENTRAL

Jesse Selvey-James Johnson Memorial Scholarship

WOMEN OF CENTRAL

Martha J. Christmas Scholarship

Reverend Dr. Alice C. Price Educational Scholarship

Current College Undergraduates
FACE Book Stipend*

*FACE awards are funded by Sunday scholarship offerings & events.

Graduate Recognition Sunday

June 22nd | 10 AM Worship

For All Central Disciples, December 2024/
School Year 2025, Kindergarten
to Graduate School
Graduates



  @CBCSTL | cbcstl.org/live

Forms Due Saturday, May 31st



NURSERY MINISTRY

(6 months to Pre-K)

LITTLE HANDS, BIG HEARTS:
3-Part Training for Nursery Volunteers (18+)

Registration Required by Sunday, April 6th



Tuesdays, April 8th & 22nd | 7 PM



856 6534 6307 Passcode: Nursery

Saturday, April 26th | 10 AM

In-Person: Sanctuary Lower-Level Nursery

Dance Ministry!

REHEARSALS FOR AGES 6-106

ABLE-BODIED MALES & FEMALES WITH THE HEART TO MINISTER

TUESDAYS

6-8 PM

**REVEREND
T.E. HUNTLEY
CHAPEL**

Worship the Lord with mind, body & soul!

FOR MORE INFO: DISCIPLE TINA PARKER | 314-570-5886

"Investing In Hope"

PHASE 2 | CENTRAL BAPTIST CHURCH CAPITAL CAMPAIGN

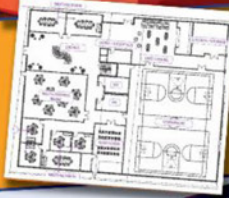

- Renovate the Educational Center to create children & youth-focused spaces
- Replace the Warehouse roof
- Raise funds to match \$10K grant for Central Gardens
- Tackle small ADA updates
- Start Capital Endowment

March 3, 2024 - March 30, 2025
Goal \$142,400

- 400 cheerful givers in addition to tithes & offerings:
 - Adults \$356 each over the next 12 months
- \$178 in honor of our heritage + \$178 in hope for our future
 - Less than \$7 per week
- Youth \$35.60 each over the next 12 months
- Children \$3.56 each over the next 12 months



FEEDBACK FORM



GIVE ONLINE

MENTAL HEALTH RESOURCES

BREAK THE SILENCE, END THE STIGMA

988 Suicide & Crisis Lifeline
988 | 800-273-TALK | 988lifeline.org

National Domestic Violence Hotline
800-799-SAFE | Text START to 88788 | thehotline.org

National Sexual Assault Hotline | 800-656-HOPE | rainn.org

CrisisTextLine.org | Text HOME to 741741

ChildHelp.org National Child Abuse Hotline | 800-4-A-CHILD

National Human Trafficking Hotline
888-3737-888 | Text 233733 (BeFree) | humantraffickinghotline.org



CENTRAL BAPTIST CHURCH HEALTH & CANCER SUPPORT MINISTRIES

FOR ACTIVE & RETIRED HEALTHCARE PROFESSIONALS
(MD, RN, LPN, EMT, NA, RT, OTHERS)

FOR THOSE DESIRING CANCER SUPPORT
AS PATIENT OR CAREGIVER

FOR NON-PROFESSIONALS WHO WANT
TO SERVE OTHERS

3RD SATURDAYS

11 AM | IN-PERSON

LET'S COME TOGETHER FOR LIFE!

CENTRAL BAPTIST CHURCH

HYBRID
SUNDAY SCHOOL
8:30 AM

Rev. T.E. Huntley Chapel |  279 619 4208

PRaise WORSHIP PRAYER SCRIPTURE WORD FUN!

 Hybrid
CHILDREN'S CHURCH

GRADES K-5

Sundays 10 AM
Educational Center Gym

ID 853 3278 0260
Passcode: Kids
SNACKS SERVED



EVERY SUNDAY @ 10 AM

THE REUNION

ONLINE & IN-PERSON

HYBRID YOUTH WORSHIP

E-MAIL
CBCYOUTHMIN@GMAIL.COM
FOR ZOOM INFO

CENTRAL BAPTIST CHURCH
YOUTH MINISTRY
AUGUST 12-18

@cbcsouthwestministry
Central Baptist Church Youth Ministry St. Louis
Rev. Anthony L. Wiley, Senior Pastor

COME FISH WITH US

LUKE 5:7

CENTRAL BAPTIST CHURCH

YOUTH MINISTRY

IS IN NEED OF
TEACHERS & TECH SUPPORT
PLEASE E-MAIL
CBCYOUTHMIN@GMAIL.COM
IF INTERESTED

CENTRAL BAPTIST CHURCH
YOUTH MINISTRY
AUGUST 12-18

@cbcsouthwestministry
Central Baptist Church Youth Ministry St. Louis
Rev. Anthony L. Wiley, Senior Pastor

CENTRAL BAPTIST CHURCH

Prayer Call!

Mondays 6:30AM



 ID: 964 4322 7626
Dial-in: 312-626-6799

CENTRAL BAPTIST CHURCH

In-Person

Prayer Ministry

Wednesdays | 11AM in the Sanctuary



Making Disciples... Transforming Lives

Some of Our Ministries | All Are Invited!

Mature Adult Ministry (56+) | 1st Wed 1:30 PM
Hybrid: 2842 Washington Blvd | Midtown St. Louis, MO
or  973 1888 8057 Password 222626

Sewing & Quilting | Thu 12 PM
2845 Washington Blvd | Midtown St. Louis, MO

Comfort Keepers Group Grief Support | 2nd Sat 10 AM
 943 7504 8782



Making Disciples... Transforming Lives

Women of Central Fellowship & Bible Study | 3rd Sat 10 AM
Hybrid: 2842 Washington Blvd | Midtown St. Louis, MO
or  971 5355 3073

Men of Central | 3rd Sat 10 AM
2845 Washington Blvd | Midtown St. Louis, MO

Health & Cancer Support Ministries | 3rd Sat 11 AM
2845 Washington Blvd | Midtown St. Louis, MO

SALVE Singles Ministry | 4th Fri 7 PM (3rd Fri Nov-Dec)
 965 4663 4722 Password 225587



CONNECT WITH CENTRAL BAPTIST CHURCH

I'm New
Let Us Know You Are Here



Who We Are
Ministries & More...



Give
Online



Join
Become a Disciple



Receive Care
Receive Congregational Care



Central Shop
Our Brand



CENTRAL BAPTIST CHURCH NEW WEBSITE LAUNCHED CBCSTL.ORG

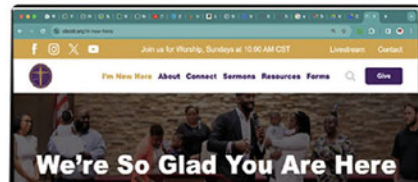

The Website Team!

CENTRAL BAPTIST CHURCH Get Connected Today!

Why Should I Connect?



- Update your personal info
- Give via Realm & Central is not charged a fee
- Manage your giving
- Communicate with Central ministries & teams
- Connect with other Central disciples
- Join Central events
- Keep up with Central news

How Do I Connect?

- Search for Feb 2024 email "Central Baptist Church: Join our online community!"
- Don't see it? Request a new Realm email from Leah Nolden: lnolden@cbcstl.org | 314-533-0747
- Click the email link and create a password.
- Update your profile and privacy settings to what you would like visible to others.
- Download the Realm Connect app and/or just visit online and explore!

QR Codes for Mobile Apps



Android App



Apple iTunes App



Let's be the church...together.

CENTRAL BAPTIST CHURCH MIDDLE ADULT CONNECTION (MAC) THE FELLOWSHIP MINISTRY ACHIEVING GOD'S WILL FOR AGES 35-55!

BI-MONTHLY GET-TOGETHERS

SOME FOR MIDDLE ADULTS
SOME WITH OUR CHILDREN

TO GET CONNECTED

BY EMAIL

& GROUPME,

REACH OUT TO

DISCIPLE CHRIS BARTLEY

CBFLY30@GMAIL.COM | 314-346-1476

CENTRAL BAPTIST CHURCH

FREE COMMUNITY MEAL

TUESDAYS 11:45 AM

VOLUNTEER WORKERS:
11:30 AM

DEVOTION & MEAL

2845 Washington Blvd | Midtown St Louis, MO

CENTRAL BAPTIST CHURCH

Every
Sunday
9-10 AM
&
After Worship



Benefiting
the Central
Youth Ministry
& School Supplies
for
Developing
Countries

- Tea, Coffee or Hot Chocolate \$3
- Trail Mix or BelVita Snacks \$2
- Bag of Coffee or Loose-Leaf Tea \$15



Disciple

Noah Temple, Founder & CEO
Youth Entrepreneur & Visionary

Please No Food or Drinks in the Sanctuary

QR CODE CARD

Use your cell
phone & take a
picture of the
QR code you
want to use!

CENTRAL BAPTIST CHURCH



Reverend Anthony L. Riley, M.Div., D.Min.
Senior Pastor

I'm New
Let Us Know You Are Here



Join
Become a Disciple

Receive Care
Receive Congregational Care



Give
Online



CENTRAL BAPTIST CHURCH

CBSTL.ORG

GIVELIFY APP



ONLINE BILL PAY

OFFERINGS



WAYS TO GIVE



US MAIL/DROP-OFF
2845 WASHINGTON BLVD, 63103



SICK & SHUT-IN

CENTRAL BAPTIST CHURCH

OFFERINGS



MORTGAGE \$10



SCHOLARSHIP \$5

MONTHLY REQUESTS



BENEVOLENCE \$5



MISSION \$5

CENTRAL BAPTIST CHURCH

Intercessory Prayer

Thursdays 7PM



ID: 279 619 4208
Dial-in: 312-626-6799

CENTRAL BAPTIST CHURCH

Worship-Related Volunteers Needed!

MEDIA MINISTRY

Stagepeople

IMAG (Image Magnification)

Computer Operators

Remote Camera Operators

PUBLIC RELATIONS MINISTRY

CBCSTLnews Writers Facebook, Instagram
or Twitter Posters or Specialists

For training, see or contact
Milton Kendrick III: mkendrick@cbbstl.org

CENTRAL STAFF

PASTORAL OFFICE



**Rev. Anthony L. Riley, M.Div., D. Min.
Pastor**
Pastor@cbcstl.org



**Executive Assistant to the Pastor
Ms. Kyla Williams**
executiveassistant@cbcstl.org
Responsibilities: Disciple Meetings
with the Pastor, Pastoral
Appointments

CORE TEAM



**Operations Manager
Chip Clatto**
operations@cbcstl.org
314.533.0747
Responsibilities: Day-to-Day
Operations, Office Management,
Facility Operations, Maintenance
and Security, Human Resources,
Financial Stewardship



**Minister of Discipleship
Rev. Natasha Nedrick Adzudzor**
discipleship@cbcstl.org
314.710.0003
Responsibilities: Classes/Sunday
School, Ministries, New Members,
Student Ministries, Volunteers



**Director of Worship
Mrs. Jennifer L. Kelley**
worship@cbcstl.org
314.710.1220
Responsibilities: Choirs, Band,
Creative Arts, Experience Team,
Creativity

OPERATIONS TEAM



**Administrative Assistant
Ms. Leah Nolden**
lnolden@cbcstl.org
Responsibilities: Accounts Payable,
Contribution Statements, Contact Info
Update for Text Messages, Emails and
Voice Messaging



**Staff Accountant
Ms. Dawn Wallace**
dwallace@cbcstl.org
Responsibilities: Accounting and
Budgeting

**Receptionist
Vacant**
officeassistant@cbcstl.org
Responsibilities: Bereavement/
Funeral Support, Church Calendar,
Receptionist, Registration and Jotform
Management.

**Custodian
Anthony Burns**
Responsibilities: Facilities and Ground
Maintenance, Event Management,
Warehouse Management

STUDENT MINISTRIES TEAM



**Minister of Youth
Rev. Tracey Watkins**
cbcyouthmin@cbcstl.org



**Children's Ministry Coordinator
Ms. Marjorie Patton**
mpatton@cbcstl.org

Office Hours: Monday - Thursday 8:00am-5:00pm. | Church Office 314.533.0747



At-Home Communion | Baptism | Bereavement | Hospitalization | Prayer | You never walk alone.



Central Cares!

Acts 6:1-7

NORTH/NORTH COUNTY

Bessie Bush | 501-602-0917 | bessie.bush@att.net
 Emma Daniels | 314-650-7127 | emmapsalms34@gmail.com
 Claudine Fleming | 314-276-5472 | deltadol71@aol.com
 Sandra Ginger | 314-973-7760 | skginger1124@gmail.com
 Emem Ituen | 314-346-8833 | eituen2006@yahoo.com
 Jimmy Kellom | 314-363-6877 | jimmykellom@aol.com
 Willie Nobles | 314-477-7914 | wanobles@hotmail.com

HOSPITALS:

Christian | SSM Health DePaul | Northwest HealthCare

SOUTH/SOUTH COUNTY

Willie Bennett | 314-332-0944 | wb1243@swbell.net
 Anthony Franks | 314-539-3995 | ayefranks@sbcglobal.net
 Vernon Grandberry | 314-660-0916 | v.grandberry@att.net
 Natalie Hill | 314-537-6640 | hillnatalie10@gmail.com
 Marilyn Holmes | 314-608-5424 | merIntwomusic@gmail.com

HOSPITALS:

St. Louis - St. Anthony's | Mercy | St. Luke's Des Peres Hospital

WEST/WEST COUNTY

Tracie Chisom | 314-413-4958 | traciehope@outlook.com
 James Clark | 314-550-7897 | jeclarkcbcstl@gmail.com
 Paulette Clark | 314-974-6037 | paclark@sbcglobal.net
 Sylvester Dunn | 314-800-7154 | sylvesterdunn776@yahoo.com
 Gloria Givens | 314-229-1110 | gggivens@swbell.net
 Varon Johnson | 314-780-2081 | varondj1@gmail.com
 Bryant Kirby | 314-882-0441 | bryantkkirby@gmail.com
 Diana Redden | 314-488-4763 | dianaredden0629@gmail.com

HOSPITALS:

SSM Health-St. Mary's | Barnes-Jewish West County and Pediatrics
 Mercy St. Louis | Missouri Baptist Medical Center (MoBap)
 St. Luke's | Mercy, Mercy Rehabilitation and Mercy Children's

ILLINOIS

Diane Dean | 618-628-0193 | dean.diane4@gmail.com
 Debra Cleveland | 618-530-5190 | debccleveland3@gmail.com
 Robert Henson | 314-809-6173 | roberthenson5@charter.net

HOSPITALS:

Southern IL Healthcare Foundation | Touchette Regional
 Alton Memorial | St. Clare's | OSF Saint Anthony's Health Center
 HSHS St. Elizabeth's
 Memorial East and Memorial Belleville

ST. LOUIS CITY

Edwin Bailey | 314-229-3146 | cbcomega0163@gmail.com
 Katherine Bailey | 314-960-0535 | baileymkatherine@gmail.com
 Ernestine Gordon | 314-882-5646 | treble2@swbell.net
 Candiss Heidbrier | 314-884-8855 | chbrier@gmail.com
 Earnest Jackson | 314-229-2871 | NA
 Hope Jackson | 314-267-6260 | hope.jackson43@yahoo.com
 Zakiyyah Marshall | 314-305-1720 | zmarshall263@gmail.com

HOSPITALS:

Barnes-Jewish | St. Louis Children's
 VA St. Louis Health Care System and John Cochran Division
 SSM Health Saint Louis University
 SSM Health Cardinal Glennon Children's
 Kindred | Shriners Hospitals for Children | St. Alexius

Church Office: 314.533.0747



SCAN FOR CARE REQUEST FORM

OR VISIT: form.jotform.com/220795283753161

SICK & SHUT-IN

Names in **bold** are most recent
added or updated info.

*"Therefore encourage one another and build each other up, just as in fact you are doing."
— 1 Thessalonians 5:11*

Send a card, note or letter of encouragement with postage to:
Disciple's Name | c/o Central Baptist Church - We will forward them each week.
Updates or Questions: 314-533-0747 | AskCentral@cbcstl.org

In Hospitals & Nursing Homes

Disciple Charles Adams
Disciple Gary Cole
Brother David Gilyard (Brother of
Disciple Stephanie Royal)
Disciple Willie Mae Glenn
Disciple Norman Green
Disciple Carolyn Hoyle
Disciple Aurhree (Arthur) Jacobs
Disciple Charles Maston
Disciple Jean Shanks
Disciple Randle Smith

At Home

Deacon Dr. Katherine Bailey
Disciple Pete Barber
Disciple Paula Bush
Disciple Temekka Cannon
Disciple Joshua Carrawell
Deacon Dr. Claudine Fleming
Disciple Garrett Franks
Disciple Andrea Hairston
Disciple Andrea Howard
Disciple Martha Hurley
Disciple Bianca Jackson
Disciple Leonora Nunley
Disciple Brenda Osby
Disciple Linda Oshuporu
Disciple Geneva Palmer-Hamilton
Disciple Brenda Rodgers
Disciple Herman Smith, Jr.
Disciple Paula Washington
Disciple Clara Wilder
Disciple Pamela Wood
Disciple Terrell Woodson

BEREAVEMENT

Please keep all disciples and their families in your thoughts and prayers during bereavement!

"May the God of hope fill you with all joy and peace as you trust in him, so that you may overflow with hope by the power of the Holy Spirit."

Romans 15:13

SPECIAL PRAYER REQUESTS

Please continue to pray for:

- Reverend Anthony L. Riley, Senior Pastor
- Victims in Israel & Palestine
- Victims of Mass Shootings
- Victims of the Wildfire in Maui, Hawaii
- Federal Republic of Nigeria
- Disciple Medoria Austin and the Fuller and Lewis Families
- Disciple Cynthia Cross and Family
- Disciple Arthur Culbert
- Sister Gina G (friend of Deacon Bryant Kirby)
- Deacon Gloria Givens
- Disciple John Howard (son of Disciple Andrea Howard)
- Ms. Kathryn Johnson (sister of Disciple Betty Winger)
- Deaconess Ernestine Jones-Gordon
- Sister Yvonne Kirby (mother of Deacon Bryant Kirby)
- Disciple Joshua D. Jones
- Disciple Mary Veda Moorehead
- Sandra Newis, Smith & Nesbit family
- Disciple Folasadé Oshuporu
- Baby Autumn (Disciple Vickey Pettiford)
- Disciple Cecelia Polford
- Disciple Terry Rodgers (no calls at this time)
- Deacon Alfred Steward
- Disciple Rosalind Sykes
- Disciple Artavious Williams (great-nephew of Disciple Cecelia Polford)
- Disciple Keith Williams
- Disciple Christine Winfield
- Bryan Young (Brother of Disciple Elaine Young & Disciple Sylvia Weaver)

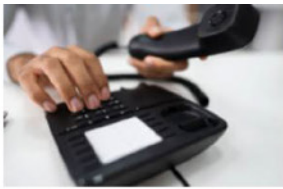

DIAL-IN: 312-626-6799

COMMUNITY BULLETIN BOARD

Please note: Some Ads have links to the associated web page, just click on link.



IN UNISON Chorus Community Concert

slso St. Louis
Symphony
Orchestra

slso.org
314-534-1700



April 27 Sun 7:00pm; Doors open 6:30pm
Greater Grace Church • 3690 Pershall Rd, Ferguson, MO 63135

Kevin McBeth, conductor
Dr. André Thomas, guest conductor
St. Louis Symphony IN UNISON Chorus
Kevin McBeth, director

Don't miss this inspirational and moving concert by the St. Louis Symphony IN UNISON Chorus, featuring guest conductor Dr. André Thomas, Associate Artist at the London Symphony.

No tickets are needed, but RSVPs are requested. Seating is general admission and available on a first-come, first-served basis. **RSVP at slso.org/iuc-commconcert.**

Supported by Bayer Fund

JOIN US FOR THE
2025
St. Louis
MUSICIAN'S AWARDS
In Loving Memory Of
Rev. Dr. Quincy Fielding Jr. & Lady Ethel McDuffy-Foster

Awardees

| | |
|----------------------------|------------------------|
| Lady Zella Jackson - Price | Min. Donald Gill |
| Dr. Timothy Whitley | Ron Green |
| Min. Ralph Long | C. Dion "Butch" Woodie |
| Ernestine Jones - Gordon | O. J. Turner |
| Eric "Snoopy" Tyler | Freddy Spencer Jr. |
| Denise Atty | Ken Black |
| Bishop Giovanni Johnson | Charles Smotherson Jr. |
| Chris Jones | Kevin Doyle |
| Nikita Ervin | Marjorie K. Patton |
| Pastor Eddie Morris | Jesse Prather |
| Dr. Doris Jones - Wilson | |

Dr. Errol Wayne Evans
Founder
Minister Christian Berry
Chairperson

First Baptist Church of Crestwood
9916 E. Watson Rd
St. Louis, MO 63126

5K
Race for Reconciliation
RUN, WALK, OR ROLL
in person or virtually to support unity, equity, & Juneteenth weekend!
Choose MCU at registration to direct all proceeds of your ticket to our mission!

SATURDAY, JUNE 14TH

Start time 8:30 AM
Starts at Delmar Blvd & De Baliviere Ave.
Finish at the same place

GROUPS OF 4 OR MORE RECEIVE 10% DISCOUNT! PERSON INCLUDES A RACE T-SHIRT AND COMMEMORATIVE MEDAL

CONTACT FOR MORE INFORMATION:
p. 314 387-3484
e. office@mcustl.com

Early Bird Prices until 5:14:
5K Run (timed) - \$25
1 mile Fun Run/Walk - untimed - \$20
Virtual 5K Run/Walk - \$20

ONLINE REGISTRATION IS REQUIRED. PLEASE VISIT:
stlr4r.com

League of American Orchestras

Student Membership

Founded in 1942, the League of American Orchestras champions the vitality of music and the orchestral experience, supports the orchestra community, and leads change boldly. Join the League to become an orchestra insider and make personal connections in this national network of 1,600 organizations and individuals.

Student membership is best suited for those currently enrolled in college (including both undergraduate and advanced degree programs) and is also open to those who recently graduated.

Student Membership - FREE!

Receive all the benefits of Individual Membership at a discounted price, including access to:

- Free early bird registration* for the League's National Conference in June.
- Member savings on all events, including webinars and seminars.
- Online programming throughout the year on topics specially tailored to students.
- League360 online member forums, including a group just for student members.
- Bi-weekly roundup of orchestra news from Symphony.
- Part of a League member organization? Upgrade your inherited benefits with a 50% discount on a Professional Membership.

*Free registration is limited and first-come, first-served. After we run out, students can attend at a deeply discounted rate.

Student Professional Membership - \$80

If you are interested in developing your career in the orchestra field, Student Professional Membership is designed for you. You will receive all of the benefits of Student Membership plus:

- Access to the League's Job Listings website with listings and notifications of available positions.
- You can post your resume where it is available to member orchestras looking for new employees.
- A copy of the annual print edition of Symphony magazine.

americanorchestras.org/students



Photos of students performing and speaking at the 2023 League National Conference by Jason Cohn.



St. Louis Society for the Blind and Visually Impaired

Since 1911 the Society has been enhancing independence, empowering individuals and enriching the lives of people who are visually impaired or blind.

It is our goal to reach diverse and underserved populations of the blind and visually impaired.

To increase awareness of products and services to the minority blind community.

To ensure equity and inclusion for all ethnicities.



Come see how we can help!

8770 Manchester Road
Brentwood, Missouri 63144
314-968-9000 | www.slsbvi.org



Visit our website





Are you interested in learning skills in the arts industry that can lead to employment and/or prepare you for a career as a jewelry designer, musician, dancer, seamstress or costume designer, digital storyteller, and in museum visitor services?

If your answer is "YES," then Better Family Life has a program for you.

Sankofa Rising offers paid internships, transportation reimbursement, utility and housing assistance, and financial incentives for attendance for those who qualify.

Career Readiness Program



REQUIREMENTS FOR PARTICIPATION:
Must reside in St. Louis City or County.

Age 18 and older and receiving TANF (Temporary Aid for Needy Families)

Age 18 and older and eligible to receive TANF



Call Today: 314.367.3440, ext. 306 or 501
Email: sankofarising@betterfamilylife.org

Funding Partner



Sankofa Rising is a program of Better Family Life, Inc. It is funded by a grant from the MO. Dept. of Social Services

Play your part with the Symphony Volunteer Association

Volunteer for the SLSO! There are many fulfilling activities our volunteers enjoy.

Concert day opportunities*

- Greet guests arriving to concerts
- Share donuts, hot coffee, and warm smiles prior to Coffee Concerts
- Assist with Youth Orchestra and special event activities

*Volunteers receive complimentary tickets for concerts when volunteering

Education opportunities

- Welcome up to 2,000 children at imaginative education concerts
- Create links between music and art for students across the region with Picture the Music
- Assist with pre-concert activities before Concerts for Kids





Online and at-home opportunities

- Socialize with SLSO musicians and staff through unique virtual/online experiences
- Serve as an advocate for the arts by contacting legislators to secure arts funding
- Help thank fellow supporters of the SLSO
- Assist with communications and more!

Visit slso.org/sva to learn more and join the SVA today! Volunteer benefits include occasional complimentary concert tickets, meeting musicians, special programs, social events, and best of all, the joy of giving back!



St. Louis Symphony Orchestra

Stéphane Denève : Music Director

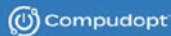

Computer Giveaway

Register for your chance to receive a **FREE COMPUTER**



Hello St. Louis families!

Don't have a working computer at home? **We're here to help!**

Compudopt's goal is to make sure **all families** have the access they need to thrive in today's digital world. That's why we are a non-profit organization dedicated to providing computers and free or low cost internet solutions to families who need them.

Compudopt treats the security of our users' private information as our number one priority; that's why we will never sell your data and instead only use it to help you better access the digital tools, connectivity, and support you've requested. No purchase necessary and no age restriction to participate. Compudopt is not responsible for any lost, stolen, or personally-damaged devices. Device recipients will be determined by the selected Community Based Organizations. The devices will be provided on a first-come, first-served basis while supplies last. Compudopt reserves the right to modify or cancel the event for any reason. See event staff for full terms and conditions.

To qualify for the computer giveaway, you must not currently own a working computer at home. **Computers come with a 2-year warranty and free tech support!**

Scan the QR code or visit compudopt.org/st.louis to register! Families are randomly selected and will be notified via text and email if selected.



Register today!

Questions? Call: 855-532-5060.

Empowering youth through technology.

Power. Learn. Thrive.

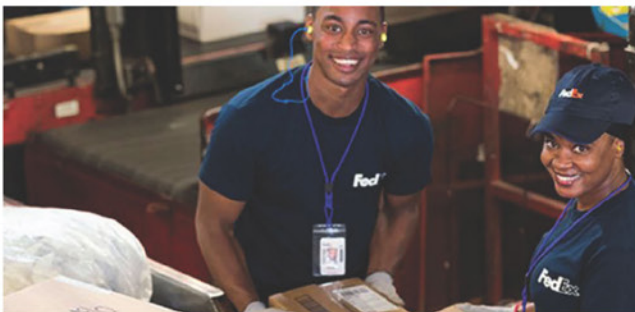

NOW HIRING Package Handlers

FedEx
Ground

EOE, including disability/vets
* Compensation may vary depending on location, job title, and hiring company.
Visit our Careers website for more information.

Message and data rates may apply. Text 101.4 to 55111 for help. Text STOP to 55111 to cancel.
FedEx is an equal opportunity employer. We are an equal opportunity employer. We are an equal opportunity employer.

MAINTENANCE TECHNICIAN OPPORTUNITIES

FedEx Locations

9000 Premier Parkway, St. Peters, MO 63376 Up to **\$40.50** /hr*

PACKAGE HANDLER OPPORTUNITIES

1525 Woodson Road, MO 63114

Preload Sort start time 3AM, \$17.35 Up to **\$17.35** /hr*
Outbound Sort start time 4PM, \$16.35

9000 Premier Parkway, St. Peters, MO 63376

Preload Sort start time 3AM, \$19.70 Up to **\$20.70** /hr*
Outbound Sort start time 4PM, \$17.00
Midnight sort start time 10PM, \$19.70
Fulltime, \$20.70

1602 Sauget Business BLVD, East St. Louis, IL 62206

Preload Sort start time 3AM, \$18.40 Up to **\$18.40** /hr*
Outbound Sort start time 4PM, \$16.40

QUALIFICATIONS:

- Must be at least 18 years of age
- Must be able to load, unload and sort packages, as well as perform other related duties

BENEFITS INCLUDE:

- Tuition reimbursement program
- Career advancement opportunities
- Weekly pay/direct deposit
- Benefits available upon reaching eligibility requirements



To apply:
Scan the QR code to text FedEx to 288000
or visit careers.fedex.com

ST. LOUIS COUNTY HIGH SCHOOL STUDENT ELECTION JUDGE PROGRAM

EARN COMMUNITY SERVICE HOURS OR
GET PAID FOR YOUR TIME

REQUIREMENTS:

- Be a United States citizen
- Be at least 15 but under 18 and in the 10th, 11th or 12th grade
- Be in good academic standing
- Have permission from parent or legal guardian and school
- Be willing and able to serve their assignment from 5 a.m. to approximately 8 p.m. on Election Day
- Be able to attend election training
- Have transportation to and from the assigned polling place
- Not be related to a candidate on the ballot
- Work without partisan bias and without promoting any point of view on a candidate or issue

INTERESTED?

Visit vote4stlco.com/policeaccess
or call 314-615-1858.

**St. Louis
COUNTY
ELECTION BOARD**
725 Northwest Plaza Drive
St. Ann, MO 63074

[f](https://www.facebook.com/stlouiscountyvotes) [i](https://www.instagram.com/stlouiscountyvotes) [t](https://www.tiktok.com/@stlouiscountyvotes)

STIPEND \$170

**COMMUNITY
SERVICE 16
HRS**



**CALL 314
615 1858**